

GPS 2000 QM

*Active Receiving Antenna for the 1575 MHz
NAVSTAR GPS Satellite Navigational
System for Landmobile Use*



DESCRIPTION:

- ★ Flat-pack GPS-antenna for fixed installations.
- ★ Full hemispherical coverage.
- ★ Built-in high gain, low noise amplifier.
- ★ Right-Hand Circular Polarisation (RHCP).
- ★ Available in black.
- ★ 5 V supply voltage (3 V respectively 12 V available on request).
- ★ DC supply via RF-connector.
- ★ EMC tested to IEC 801 and IEC 255.
- ★ Provided with FME (female) connector.
- ★ Wide range of FME-accessories available.
- ★ Double-adhesion procedure ensures fast and reliable fixing.

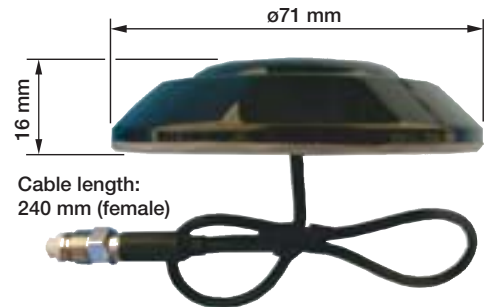

SPECIFICATIONS:

| ELECTRICAL | |
|-------------------------------|---|
| General Specifications | |
| MODEL | GPS 2000 QM |
| ANTENNA TYPE | Active patch antenna |
| FREQUENCY | 1575 MHz |
| IMPEDANCE | Nom. 50 Ω |
| POLARISATION | Circular right-hand |
| COVERAGE | Hemispherical |
| GAIN (in axial direction) | 28 dBic (typ.) |
| CROSS-POLARISATION ATT. | > 10 dB (typ.) |
| Built-in Amplifier | |
| GAIN | > 30 dB (typ.) |
| NOISE FIGURE | ≤ 1 dB (typ.) |
| 1 dB COMP. POINT | Approx. +7 dBm |
| SELECTIVITY | > 45 dB down at ± 45 MHz |
| SWR (output) | ≤ 2.0 |
| SUPPLY VOLTAGE | 5 ± 0.5 VDC (3 V respectively 12 V available on request) |
| CURRENT CONSUMPTION | Approx. 20 mA |
| MECHANICAL | |
| MOUNTING | 10 mm dia. hole |
| MATERIALS | Cu-nite brass Seawater resistant Lexan |
| COLOUR | Black |
| TEMP. RANGE | -30° C → +70° C |
| CONNECTOR | FME (female) |
| HEIGHT | Approx. 16 mm |
| WIDTH/LENGTH | ø71 mm |
| WEIGHT | Approx. 90 g |

GPS 2000 QM

Active Receiving Antenna for the 1575 MHz
NAVSTAR GPS Satellite Navigational
System for Landmobile Use



1. BEFORE INSTALLATION:

- ★ Environmental and car temperature must be above 15° C at installation, and installation surface must be dry and clean.

2. INSTALLATION:

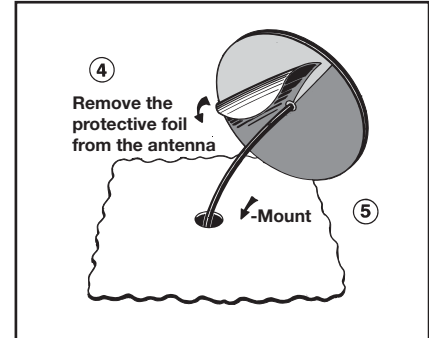
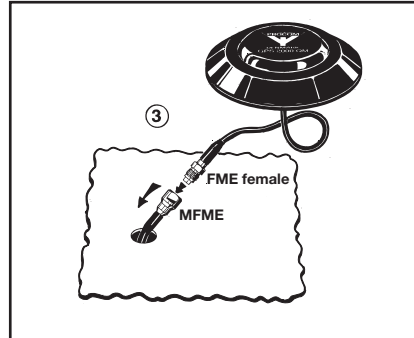
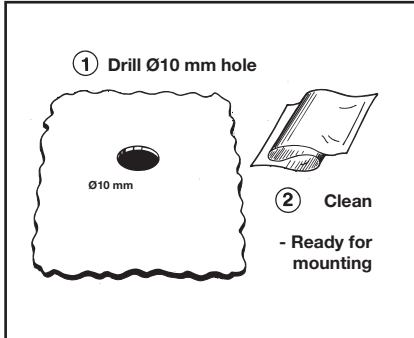

3. ADHESION ADVICE:

- ★ It is essential for a good adhesion result that the surface is properly cleaned and dry.
- ★ A high application pressure improves the binding power.
- ★ Ideal application temperature range is +20° C to +38° C but may be extended down to +15° C. When applied binding strength is maintained between -30° C and +70° C.

TYPICAL RESPONSE CURVES:

Do not use sealer on rubber gasket or other places.

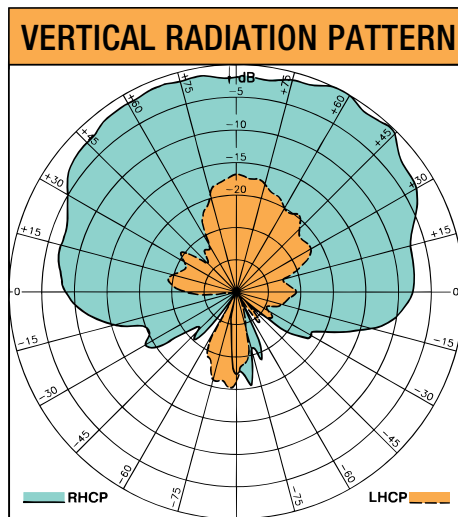
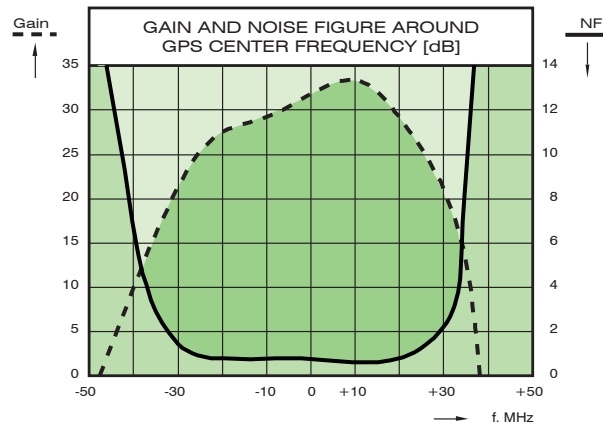
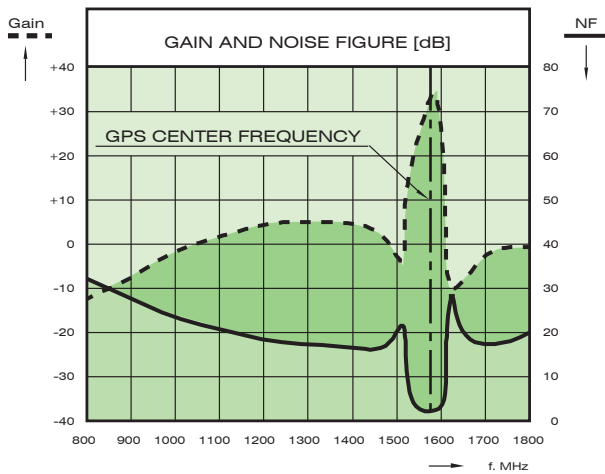

FME-SYSTEM ACCESSORIES

FME-CABLES

| LENGTH | TYPE NO. |
|-----------|---------------|
| 1m | 1m FME |
| 2m | 2m FME |
| 3m | 3m FME |
| 4m | 4m FME |
| 5m | 5m FME |
| 6m | 6m FME |
| 4m white | 4m FME-white |
| 6m white | 6m FME-white |
| 12m white | 12m FME-white |
| 18m white | 18m FME-white |

For further information about other types of FME-cables please compare the cable data sheets under accessories in our catalogue.

FME-SYSTEM ACCESSORIES

FME-CONNECTORS

| CONNECTOR | ORDER NO. |
|--------------|-----------|
| FME-FME | FME-FME |
| Prolongation | FMEP |
| N | FME-N |
| FSMA | FME-FSMA |
| BNC | FME-BNC |
| TNC | FME-TNC |
| UHF | FME-UHF |
| Mini-UHF | FME-MUHF |
| Elbow-MUHF | FME-EMUHF |
| Elbow-BNC | FME-EBNC |
| Elbow-TNC | FME-ETNC |
| SMA | FME-SMA |