

# HX 30-KZ

Very Short Helical Mobile Antenna  
for the 30 MHz Band

PROCOM

## DESCRIPTION:

- ★ Ultra-short ( $0.03 \lambda$ ) mobile antenna for short-distance communication.
- ★ Ideal where normal-sized antennas cannot be used, as on building-site machines, forest vehicles etc.
- ★ Amazingly good performance despite a very low height, due to top loading.
- ★ Stainless steel Z-mount with ball-joint and wing screw whip-fastening system.
- ★ Simple mounting exclusively with access from the outside.
- ★ Ready-tuned and tested from the factory to assure minimum SWR.
- ★ Choice between two connection principles:
  - ★ Z-mount : FME-connection (supplied without cable).
  - ★ ZP4-mount : Permanently attached 4 m cable terminated with FME-connector.

Z-Mount

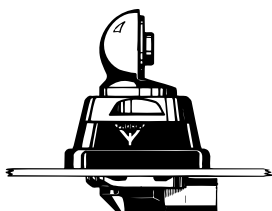

ZP4-Mount

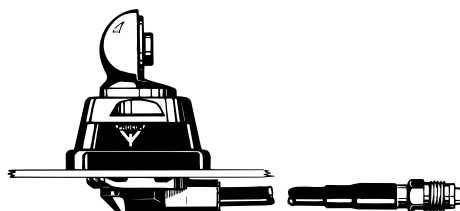

## ORDERING DESIGNATIONS:

MOUNT VERSION	Z-mount with FME-system	ZP4-mount with 4 m cable and FME connector
ANTENNA TYPE NO.	HX 30-KZ	HX 30-KZP4

## SPECIFICATIONS:

ELECTRICAL	
ANTENNA TYPE	Toploaded helical mobile antenna
FREQUENCY	30 MHz band
IMPEDANCE	Nom. 50 $\Omega$
POLARISATION	Vertical
BANDWIDTH	$\geq 250$ kHz at SWR $\leq 2.0$
SWR	$\leq 1.3$ at f. res.
MAX. POWER	5 watt
MECHANICAL	
MATERIALS	Whip: Electroplated steel helix moulded in elastomer Chromed brass
	Mount: Chromed brass Environment-proof plastics Stainless steel
RECOMMENDED INSTALLATION TORQUE	$7.5 \pm 1$ Nm
COLOUR	Black
HEIGHT	Approx. 32 cm
WEIGHT	Approx. 330 g
MOUNTING	21 mm dia. hole

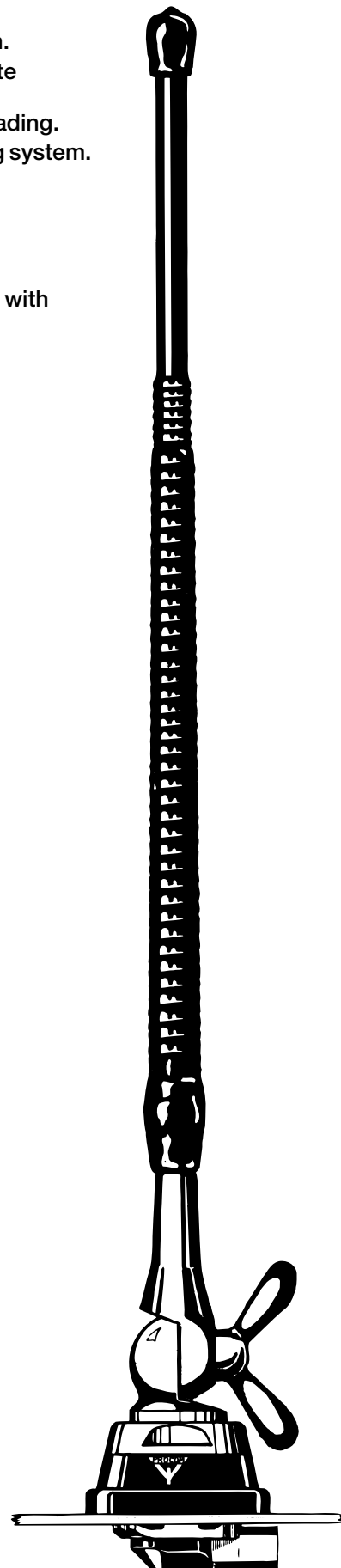

# HX 30-KZ Installation



This antenna is provided with type Z-mount. The whip is fastened to the mount by means of our standard ball-joint and wing screw system. The adjustable ball-joint ensures that the whip can always be mounted in a vertical position independent of the angle of the installation spot.

The Z-mount is particularly well suited for mounting on car-roofs because of its ability to be installed exclusively with access from the outside. However, the antenna can be installed anywhere on the car, as the Z-mount is equally well suited for mounting on e.g. trunk or wing.

## 1. INSTALLATION DIMENSIONS:

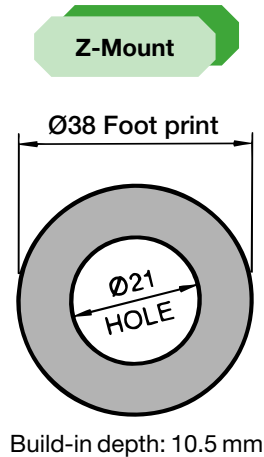

## 2. INSTALLATION STEPS:

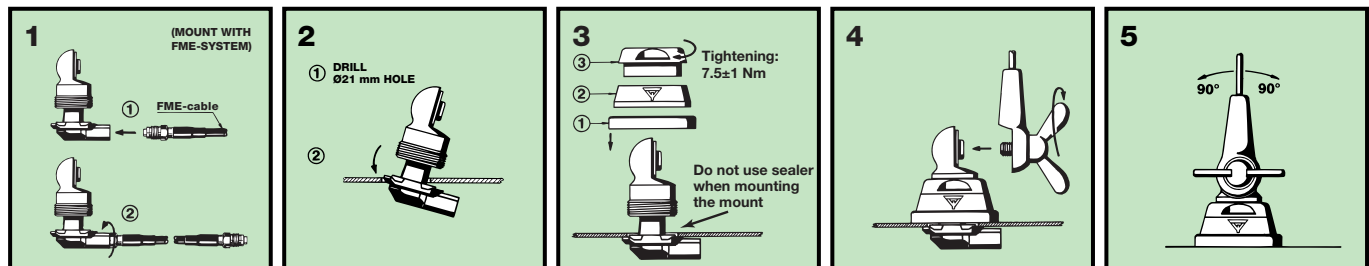

## 3. TUNING:

The antenna is factory-tuned for minimum SWR.  
No additional tuning is required.