

MU 11-X/...

Colinear 4 dB Mobile Antenna
for the 450 MHz Band



DESCRIPTION:

- ★ Encapsulated phasing coil.
- ★ Black-chromed, stainless steel whip.
- ★ Choice between general purpose tunable models and permanently tuned models for cellular networks.
- ★ Stainless steel X-mount with M6-thread whip-fastening system.
- ★ Simple mounting exclusively with access from the outside.
- ★ Models available with X-mount (oblong) and CX-mount (circular).
- ★ Choice between two connection principles:
 - ★ X-mount : FME-connection (supplied without cable).
 - ★ XP4-mount: Permanently attached 4 m cable terminated with FME-connector.

X-Mount

CX-Mount

XP4-Mount

CXP4-Mount

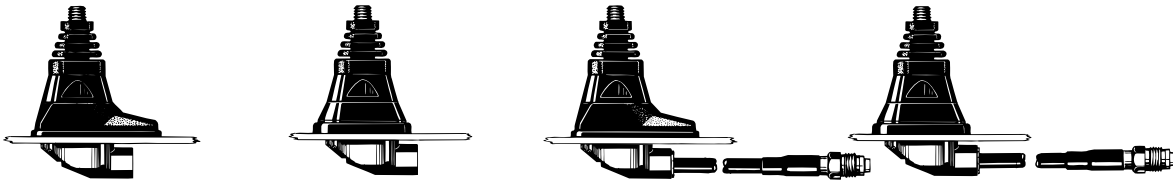

SPECIFICATIONS:

ELECTRICAL	
ANTENNA TYPE	Colinear stainless steel whip mobile antenna
FREQUENCY	450 MHz-band covered by four models
IMPEDANCE	Nom. 50 Ω
POLARISATION	Vertical
GAIN	4 dB (acc. to EIA RS-329)
BANDWIDTH	≥ 20 MHz at SWR ≤ 1.5
SWR	≤ 1.3 at f. res.
MAX. POWER	100 watt
MECHANICAL	
MATERIALS	Whip: Black-chromed stainless steel and brass Durable plastics Mount: Black chromed brass Environment-proof plastics Stainless steel
RECOMMENDED INSTALLATION TORQUE	4 ± 1 Nm
COLOUR	Black
HEIGHT	Approx. 60 cm (dep. on freq.)
WEIGHT	X-version : Approx. 160 g XP4-version : Approx. 300 g
MOUNTING	18 mm dia. hole

To help selecting the correct model for a specific cellular network, please consult the survey of cellular network frequencies under USEFUL DATA in our catalogues.

All whips are compatible with all mounts.



ORDERING DESIGNATIONS:

MOUNT VERSION	X-mount (oblong) with FME-system	CX-mount (circular) with FME-system	XP4-mount (oblong) with 4 m cable + FME-connector	CXP4-mount (circular) with 4 m cable + FME-connector
TUNING RANGE	Models for general application – tunable with adjustment disc:			
380...410 MHz	MU 11-X/s	MU 11-CX/s	MU 11-XP4/s	MU 11-CXP4/s
406...430 MHz	MU 11-X/f	MU 11-CX/f	MU 11-XP4/f	MU 11-CXP4/f
420...450 MHz	MU 11-X/l	MU 11-CX/l	MU 11-XP4/l	MU 11-CXP4/l
440...470 MHz	MU 11-X/h	MU 11-CX/h	MU 11-XP4/h	MU 11-CXP4/h
FREQUENCY RANGE	Models for cellular systems – pretuned, without adjustment disc:			
414-430 MHz	MU 11-X/CEL4	MU 11-CX/CEL4	MU 11-XP4/CEL4	MU 11-CXP4/CEL4
425-440 MHz	MU 11-X/CEL3	MU 11-CX/CEL3	MU 11-XP4/CEL3	MU 11-CXP4/CEL3
440-455 MHz	MU 11-X/CEL2	MU 11-CX/CEL2	MU 11-XP4/CEL2	MU 11-CXP4/CEL2
450-470 MHz	MU 11-X/CEL1	MU 11-CX/CEL1	MU 11-XP4/CEL1	MU 11-CXP4/CEL1

PROCOM A/S reserve the right to amend specifications without prior notice.

MU 11-X/... Installation



This antenna can be mounted anywhere on the car, however, roof top mounting is always recommended. The oblong X-mount can be mounted on the often very narrow strip on the rear wing between the trunk lid and the side of the car. Mounting can take place exclusively with access from the outside when drilling an 18 mm dia. hole. Mounting can take place from the inside by drilling a 14 mm dia. hole. When mounting in a 14 mm dia. hole, remove the bottom plastic ring of the packing gasket with a sharp cutter. When cleaning the car in car-washing machines, remove the whip using a spanner, size 9 mm. After wash, refit the whip and tighten it lightly with the spanner. As the mounts are internally equipped with a bendable section, the antennas can always be adjusted to an upright position independent of the tilt angle of the installation spot.

1. INSTALLATION DIMENSIONS:

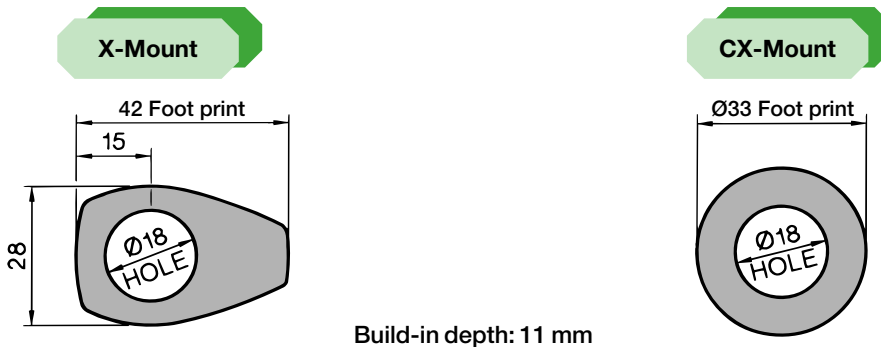

2. INSTALLATION STEPS:

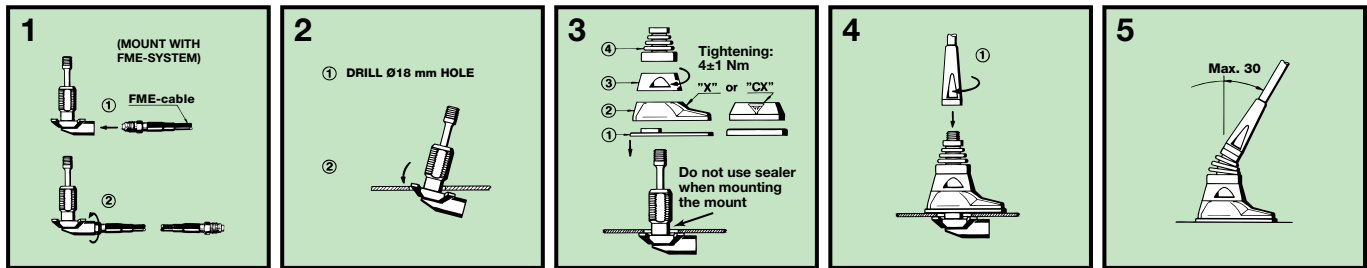

3. TUNING:

The tunable models are tuned to the desired frequency within the indicated tuning range by positioning the adjustment disc according to the diagrams below.

